

# System III®

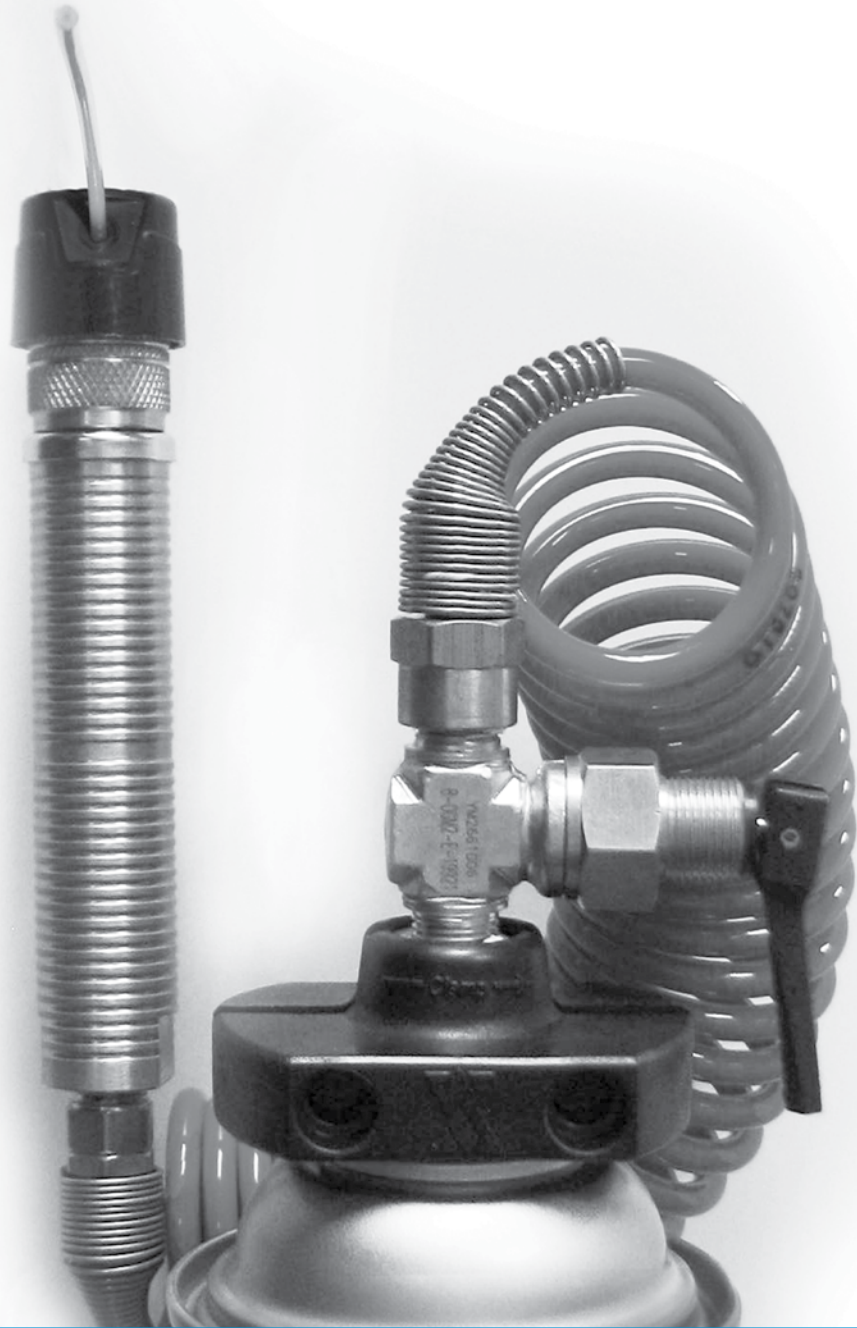

 **BASF**

The Chemical Company

## SYSTEM III®

The System III is designed to make pest management professionals even better at what they do. It makes it easy to deliver precision applications of Prescription Treatment® brand products into insect harborage areas where they eat, rest and reproduce. The small applicator and long, coiled hose make reaching hidden cracks, crevices and voids practical. And the belt mounted system makes arming yourself with all the best tools simple, lightweight and manageable; your inspection flashlight in one hand and your applicator in the other.

Integrated Pest Management (IPM) is the foundation of the Prescription Treatment Pest Management System. And it's what your customers want. The System III makes Prescription Treatment practical and profitable. Product usage is reduced with controllable applications. The System III also optimizes the flow of product, resulting in precise applications. Additionally, it extends the life of compatible PT® aerosols up to 67%.



## SYSTEM III\* PRESSURIZED PRODUCTS

	VOID INJECTOR		APPLIED WITH SYSTEM III		ADDITIONAL SECONDS	SIZE	SIGNAL WORD	FOOD HANDLING	EPA REG. #
	SEC/OZ	SEC/CAN	SEC/OZ	SEC/CAN					
<b>221L</b> Residual Insecticide 0.05% Lambda Cyhalothrin	20	350	28	481	37%	17.5 oz.	C**	Yes	499-473
<b>250 Propoxur</b> Residual Insecticide 1.0% Propoxur	20	350	28	481	37%	17.5 oz.	C**	Yes	499-501
<b>565 Plus XLO®</b> Formula 2 Contact Insecticide 0.5% Natural Pyrethrins, 1.0% PBO, 1.0% MGK-264	17	340	28	567	67%	20 oz.	C**	Yes	499-290
<b>Alpine®</b> Pressurized Insecticide 0.5% Dinotefuran	17	340	28	567	67%	20 oz.	C**	No	499-531
<b>Cy-Kick®</b> Crack & Crevice Pressurized Residual 0.1% Cyfluthrin	20	350	28	481	37%	17.5 oz.	C**	Yes	499-470
<b>MotherEarth® 2% Py</b> Contact Insecticide 2.0% Pyrethrins	20	350	28	481	37%	17.5 oz.	C**	Yes	499-520
<b>MotherEarth® Exempt</b> Contact Insecticide 6.0% Geraniol, 0.5% Lemongrass	20	350	28	481	37%	17.5 oz.	C**	No	NA
<b>MotherEarth® ProCitra-DL®</b> Contact Insecticide 10.0% d-Limonene	20	350	28	481	37%	17.5 oz.	C**	Yes	499-497
<b>Orthene***</b> Crack & Crevice Pressurized Residual 1.0% Orthene (Acephate)	20	360	28	481	37%	18 oz.	C**	Yes	499-373
<b>P.I.®</b> Contact Insecticide 0.5% Natural Pyrethrins, 4.0% PBO	25	450	36	659	46%	18 oz.	C**	Yes	499-444
<b>Phantom®</b> Pressurized Insecticide 0.5% Chlorfenapyr	20	350	28	481	37%	17.5 oz.	C**	Yes	7969-285

\* The System III is designed exclusively for BASF pressurized products labeled "For use with the System III". BASF makes no claims regarding the use of the System III on other aerosol products.  
 \*\* C=Caution \*\*\* Orthene is a registered trademark of OSM Investments, Inc. for acephate insecticide

# SYSTEM III® TROUBLESHOOTING

## If System III Will Not Spray

- 1 The shut off valve handle (13) may be in the OFF position.
  - Move the shut off valve handle to the ON position
- 2 The pressurized can may be empty.
  - Replace empty can with full one
  - See assembly instructions for details
- 3 The valve stem (4) in the gun may be clogged.
  - Replace the stem gasket (3), stem spring (5) and valve stem (4) with new components found in every case of System III compatible products
  - Tighten the gun cap (2), ensuring the gun clip (6) is pushed down into a seated position not to interfere with the gun cap seal

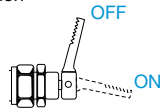

## If Leak Occurs

- 1 **If there is a leak in the hose...**
  - Remove the spring guard (10) from the nut and ferrule (9) by sliding it along the hose
  - Remove the nut and ferrule (9) from the compression fitting (8, 11)
  - Cut the hose (16) above the hole
  - Place new nut and ferrule at hose end
  - Re-attach the spring and fitting
  - Re-assemble the System III and test
- 2 **If leaking occurs at the actuator or stem gasket...**
  - If actuator (1) leaks, be sure it is seated securely on the valve stem (4)
  - If valve stem (4) leaks after use, it may be necessary to re-seat the stem to force the stem gasket (3) to flex differently
    - Turn the valve stem (4) 1/4 to 1/2 turn to reseat
    - Tighten the gun cap (2), ensuring the gun clip (6) is pushed down into a seated position not to interfere with the gun cap seal
    - If leaking still occurs, replace the valve stem, stem spring and stem gasket
- 3 **If there is a leak at the gun cap...**
  - Check to make sure the gun clip (6) is positioned properly
  - Push the gun clip (6) down into a better seated position so that it does not interfere with the gun cap seal
  - Continue to put pressure on the gun clip (6), holding it in place while you tighten the gun cap (2)
- 4 **If there is a leak at the on/off valve...**
  - Replace "O" ring

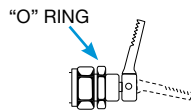

- 1 Actuator
- 2 Gun Cap
- 3 Stem Gasket
- 4 White Valve Stem
- 5 Stem Spring
- 6 Gun Clip
- 7 Gun Body
- 8 Male Compression Fitting
- 9 Nut & Ferrule for Compression Fitting
- 10 Spring Guards
- 11 Female Compression Fitting
- 12 Shut Off Valve
- 13 Shut Off Valve Handle
- 14 Double Ring Adapter
- 15 Squeeze Can Clamp
- 16 Hose

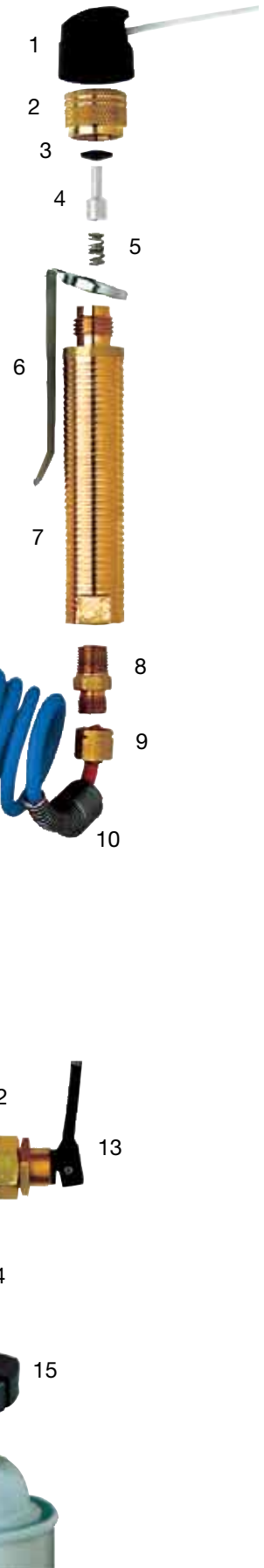

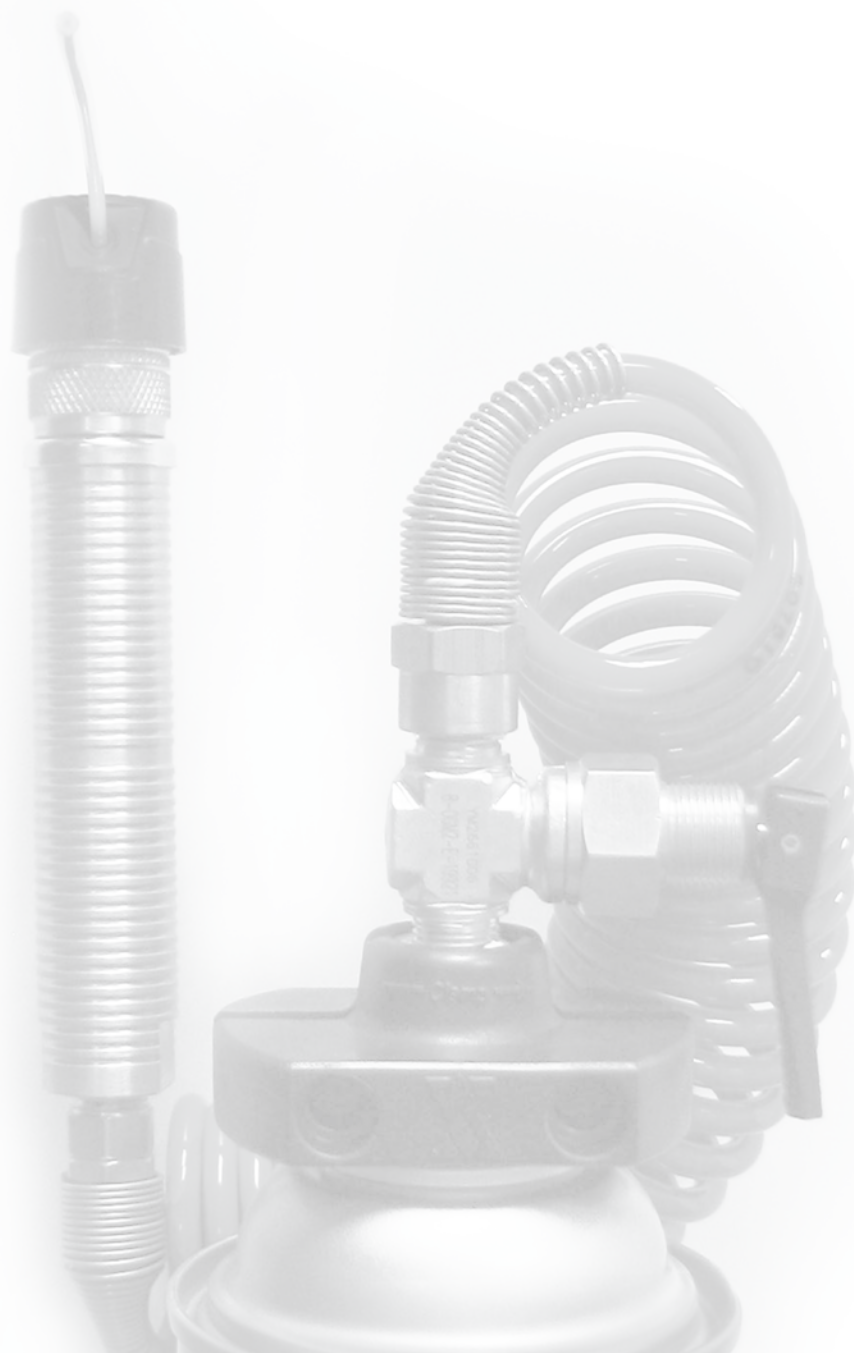

Always read and follow label directions.

[www.PestControl.basf.us](http://www.PestControl.basf.us) · 800-777-8570 · All products denoted with a © or TM are registered trademarks or trademarks of BASF.  
© 2009 BASF Corporation. All rights reserved.

09-21-155-353